

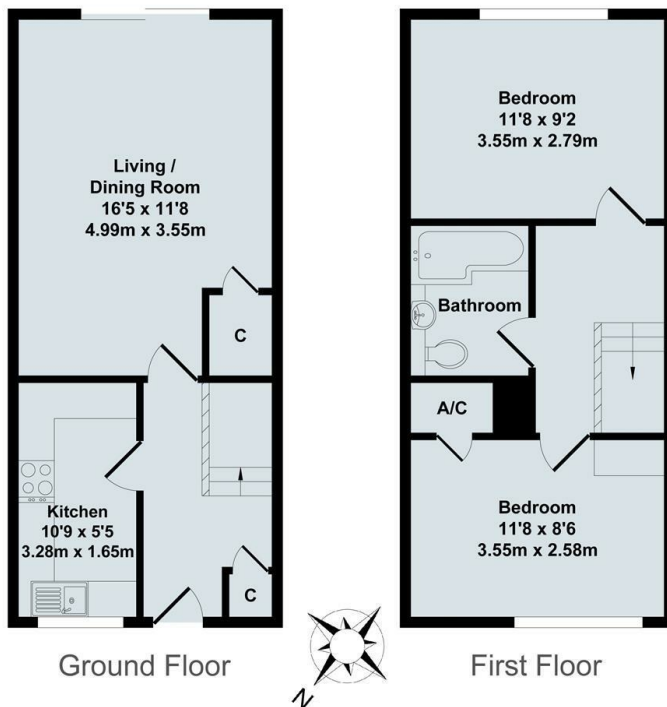

## 68 Axtell Close, Kidlington, OX5 1TW

£1,500 - 7th February 2026.

- Mid terrace house
- Two double bedrooms
- Off street parking for 1 car
- EPC rating C
- Unfurnished with appliances
- Gas CH
- Council Tax Band C
- Excellent order throughout
- Rear garden
- Mains gas electricity and water



Total Approx. Floor Area 639 Sq.Ft. (59.40 Sq.M.)

All items illustrated on this plan are included in the "Total Approx Floor Area"

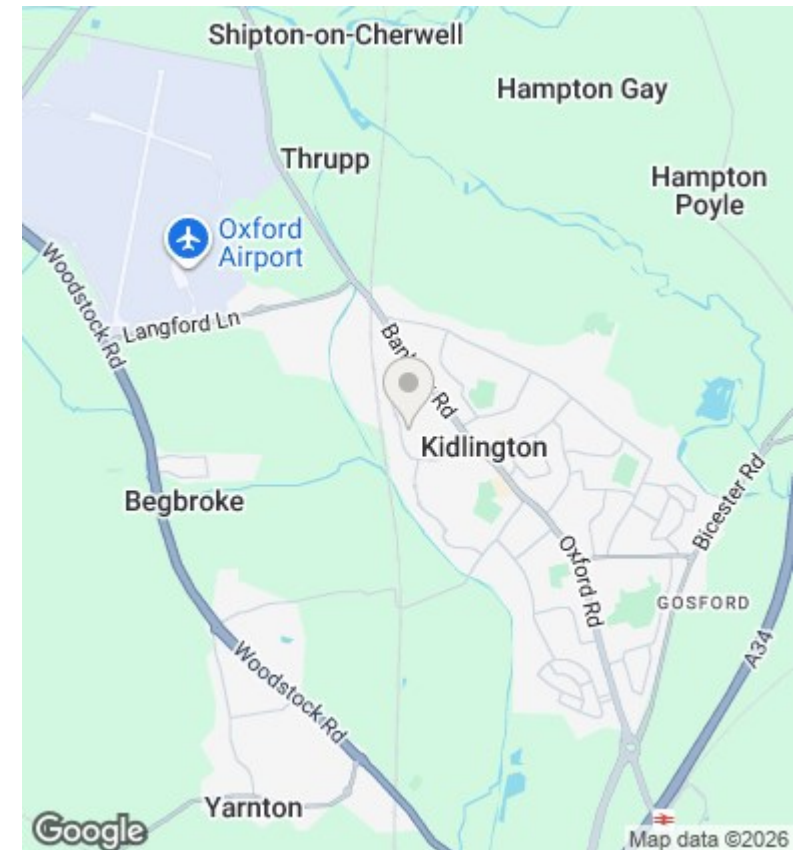

## Directions

## Viewings

Viewings by arrangement only. Call 01865 515900 to make an appointment.

## Council Tax Band

C

## EPC Rating:

C

Energy Efficiency Rating		
	Current	Potential
Very energy efficient - lower running costs		
(92 plus) <b>A</b>		
(81-91) <b>B</b>		
(69-80) <b>C</b>	75	80
(55-68) <b>D</b>		
(39-54) <b>E</b>		
(21-38) <b>F</b>		
(1-20) <b>G</b>		
Not energy efficient - higher running costs		
England & Wales	EU Directive 2002/91/EC	